

ALL EQUIPMENT IS HDPE

FF TOOL #	PART NUMBER	W '''	L '''	H '''	WEIGHT (LBS)	CUBIC FEET	NEST RATIO	REFERENCE QUANTITY/ RETURN 53.0' TRUCK	REFERENCE QUANTITY/ RETURN 50'6" RAILCAR	RAILCAR PATTERN	
										QTY/ PER PALLET	PALLET HEIGHT INCHES

### BULKHEAD SPACER

Spaces the load from front end of trailer so the weight is distributed properly over the axles to comply with regulations. Energy absorbing - compresses then recovers. AAR approved and CFR 49 compliant. Withstands 20,000 lbs of force. Stacks can be rotated and double stacked with forklift access. Nestable for efficient storage and reverse logistics. Perfect when steel bulkheads are not available.

9335	36-48-16.00	36	48	16	28.3	16	3.5:1	544	512	8	48
------	-------------	----	----	----	------	----	-------	-----	-----	---	----

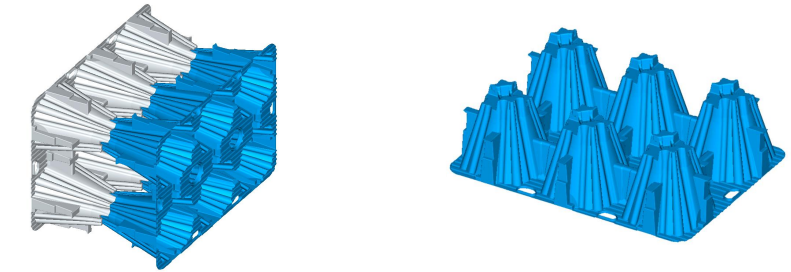

### SEPARATORS

Buffer between product and anything that might damage the product. Place between dissimilar height pallets. Use instead of honeycomb corrugated plywood. Nested parts interlock for stable return shipments and storage. Ergonomic hand holes 2:1 (2" unit) nest ratio; 2.3:1 (0.5" unit).

9495	32-75-02.00	32	75	2	17.3	2.8	2:1	1,200	1,300	50	62
10216	44-84-0.500	44	84	0.5	21	1.1	2.3:1	2,125	6,375	125	35

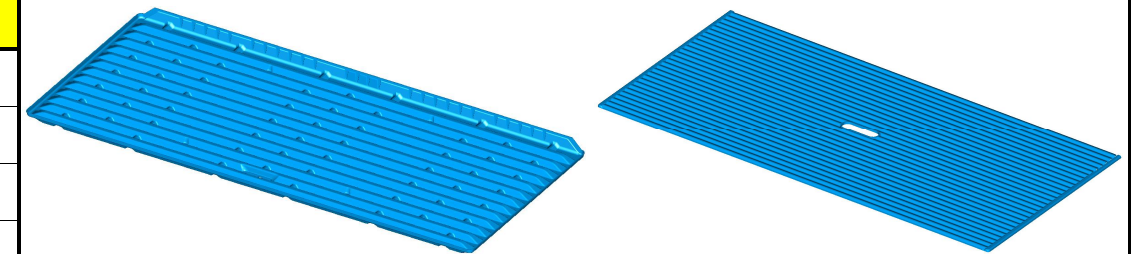

### VOID PANEL

Fills voids to prevent load shifting. Acts as a buffer between product and anything that might damage the product. Compresses, then recovers. Protection on each of an airbag. Use instead of reinforced honeycomb cardboard or plywood. Passed AAR official test at TTCI, Pueblo CO. Withstands 50,000 lbs force. Co-extruded layer for non-abrasive & non-slip

9998	48-96-04.00	48	96	4	42	10.7	1:1	312	336	14	63
10151	30-102-02.00	30	102	2	21	3.5	1:1	864	1,120	28	63
10274	48-120-04.00	48	120	4	48.9	13.3	1:1	220	280	14	63

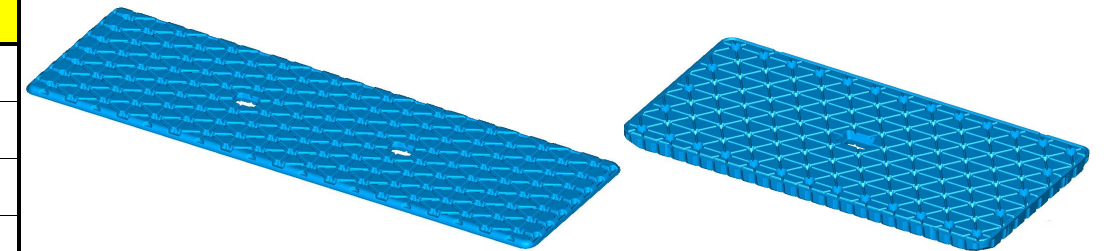

### LATERAL VOID FILLER

Fills void to prevent load shifting in lateral directions between two rows of pallets. Slide into place instead of using drop-down filler. Snap two 12" units together for 22" spacing or reverse them for 12" spacing. Snap two 9" unites for 18" spacing - reversed for 16" spacing. Nests for economic storage & reverse logistics. Passed official impact test at TTCI, Pueblo CO. Withstands 2,500 lbs. force.

9997	48-72-12/22"	48	72	12	23	24	13.4:1	1,343	1,264	79	96
10111	40-96-16/18"	40	96	9	24	20	10:1	1,245	1,245	83	96

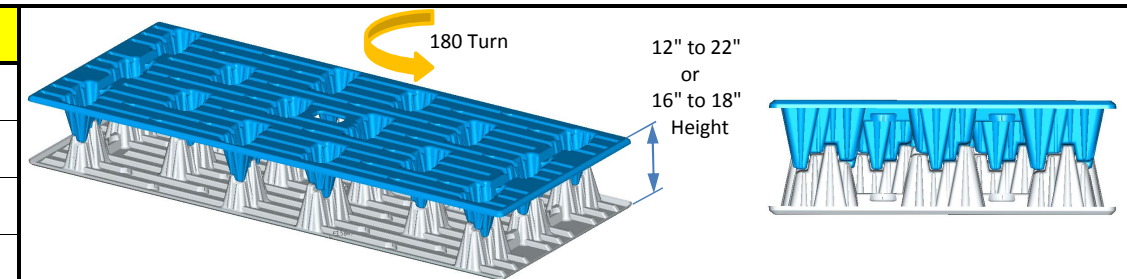

### PLASTIC BOARD

Stabilizes double-stacking. Place on top a palletized load to double /triple stack another palletized load on top of it. Maximizes warehouse space by allowing higher stacking. Distributes load more evenly on layer beneath and reduces product damage. Lighter, safer & cleaner than plywood. Ergonomic hand hole. Perfect for filling underhang void on pallets. Holds up to 3,000 lbs.

10116	40-48-01.25	40	48	1.25	16	1.4	1:1	2,760	2,760	46	52
-------	-------------	----	----	------	----	-----	-----	-------	-------	----	----

